

CARACTERISTICAS DE PISTA /
RWY CHARACTERISTICS

RWY	DIRECCION / DIRECTION	THR	RESISTENCIA / STRENGTH	TIPO / TYPE
11	108.02°	20° 31' 43.63" N 103° 19' 39.71" W	87/F/A/W/T	ASFALTO / ASPHALT
29	288.03°	20° 30' 50.66" N 103° 17' 33.60" W		
02	024.24°	20° 31' 15.21" N 103° 18' 42.22" W	52/F/A/W/T	
20	204.25°	20° 31' 57.34" N 103° 18' 16.14" W		

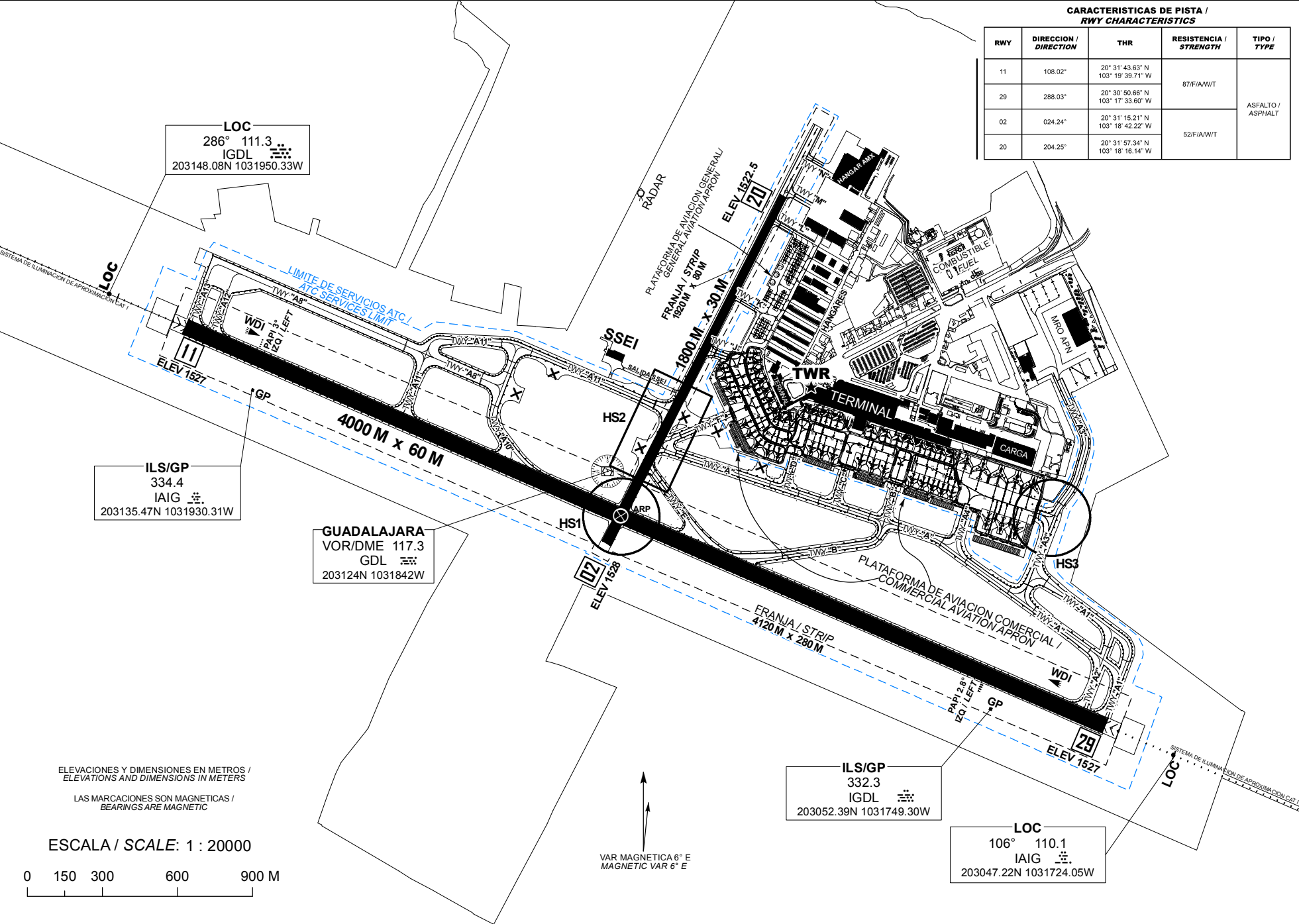

CAMBIO: HS2, PCN; TWY: A8, A10, A11, A12, A13; CNL TWY: G, H; PUNTOS DE TRANSFERENCIA

CD	132.8	APP	119.3
SMC	121.9	VOR/DME	117.3
TWR	118.1	ILS/IGDL	111.3
EMERG	121.5	ILS/IAIG	110.1

Technical drawing of the CAT I approach lighting system for Runway 11 and Runway 29. The top part shows the approach to Runway 11, including Runways A12, A12B, A11, and A10, and Taxiway D2120. The bottom part shows the approach to Runway 29, including Runways E, B, A2, and A1. Both diagrams include labels for the 'SISTEMA DE ILUMINACION DE APROXIMACION CAT I' and 'RWY'.

0 87.5 175 350 525 M

0 125 250 500 750 1000 M

MINIMOS METEOROLOGICOS / METEOROLOGICAL MINIMUMS
TECHO EN FT Y VISIBILIDAD EN SM / CEILING IN FT AND VISIBILITY IN SM

AVIACION COMERCIAL REGULAR / SCHEDULED COMMERCIAL AVIATION

DESPEGUE / TAKE OFF	
EQUIPO / AIRCRAFT	DIA Y NOCHE / DAY AND NIGHT
	RWY 11
2 MOTORES / 2 ENGINES	1/4 (400M)
3 O MAS MOTORES / 3 OR MORE ENGINES	VER NOTA* / SEE REMARK*

NOTA:
 MINIMOS DE DESPEGUE PARA AVIACION COMERCIAL REGULAR CON EQUIPO TURBOREACTOR SE REQUIERE ALTERNO PARA DESPEGUE, SI LAS CONDICIONES METEOROLOGICAS SON INFERIORES A LOS MINIMOS DE ATERRIZAJE.

REMARK:
 TAKE-OFF MINIMUMS FOR SCHEDULED COMMERCIAL AVIATION WITH JET ENGINES TAKE-OFF ALTERNATE IS REQUIRED IF THE METEOROLOGICAL CONDITIONS ARE BELOW LANDING MINIMUMS.

DESPEGUE / TAKE OFF				ALTERNO MINIMOS / ALTERNATE MINIMUMS	
EQUIPO / AIRCRAFT	DIA Y NOCHE / DAY NIGHT		DIA / DAY		
	RWY 11	RWY 29		APP ILS/ APP ILS	OTRAS APP / APP OTHERS
1 Y 2 MOTORES / 1 AND 2 ENGINES	600-1 (1600 M)	800-1 (1600 M)	VFR	600 – 2 (3200 M)	1000 – 3 (4800 M)
3 O MAS MOTORES / 3 OR MORE ENGINES	1/2 (800 M)	800-1/2 (800 M)	————		

PLATAFORMA DE AVIACION COMERCIAL / COMMERCIAL AVIATION APRON TERMINAL

POSICIONES / POSITIONS	RESISTENCIA / STRENGTH	TIPO / TYPE
PSN 1 – 10, 23 - 31	53/R/A/W/T	CONCRETO / CONCRETE
PSN 11 – 17, 21 - 22	74/R/A/W/T	
PSN 18 - 20	110/R/A/W/T	
PSN 32 – 40, 42 - 49	71/R/A/W/T	ASFALTO / ASPHALT
PSN 41	29/F/A/W/T	

PLATAFORMA DE AVIACION GENERAL / GENERAL AVIATION APRON

POSICIONES / POSITIONS	RESISTENCIA / STRENGTH	TIPO / TYPE
PSN 1 - 36	23/F/A/W/T	ASFALTO / ASPHALT

CALLES DE RODAJE, ANCHO, RESISTENCIA/ TAXIWAYS, WIDTH, STRENGTH

TWY	ANCHO/ WIDTH	RESISTENCIA/ STRENGTH	TIPO/TYPE	
A	23 M	70/F/A/W/T	ASFALTO/ASPHALT	
A1		101/F/A/W/T	ASFALTO/ASPHALT	
A2		93/R/A/W/T	CONCRETO/CONCRETE	
		107/F/A/W/T	ASFALTO/ASPHALT	
A3	25 M	93/R/A/W/T	CONCRETO/CONCRETE	
A3	23 M	70/R/A/W/T TWY "A" - COMMERCIAL APRON	CONCRETO/CONCRETE	
A4		61/F/A/W/T COMMERCIAL APRON - FBO APRON	ASFALTO/ASPHALT	
A-8	92/F/A/W/T			
A-10	69/F/A/W/T			
A-11	76/F/B/W/T			
A-11	107/F/A/W/T RWY 02/20-TWY "A-8"			
A-11	76/F/B/W/T TWY "A-8"-RWY 11/29			
A-12	77/F/A/W/T			
A-12	73/R/A/W/T			
A-13	68/F/A/W/T			
A-13	62/R/A/W/T			
B	23 M	55/F/A/W/T	ASFALTO/ASPHALT	
C		102/R/A/W/T	CONCRETO/CONCRETE	
D		60/R/A/W/T		
E		86/F/A/W/T	ASFALTO/ASPHALT	
F		69/F/A/W/T		
J		64/R/A/W/T	CONCRETO/CONCRETE	
K		17 M	30/F/A/W/T	ASFALTO/ASPHALT
L		18 M	34/F/A/W/T	
M		USO EXCLUSIVO FGR		
N		USO EXCLUSIVO AMX		

AREA DESCARGA DE COMBUSTIBLE
 QUE PODRAN SER UTILIZADAS POR LAS AERONAVES TURBORREACTORAS PREVIA COORDINACION CON LA DEPENDENCIA APROPIADA DE LOS SERVICIOS DE CONTROL DE TRANSITO AEREO

FUEL DUMPING WHICH MAYBE
 NEEDED BY TURBOJET AIRCRAFT SHALL BE COORDINATED IN ADVANCE WITH THE CORRESPONDING ATC UNIT

RUTA / ROUTE
 UJ7-27 GDL/DGO
 UJ-27 GDL/ZIH
 J42, V26 GDL/ZCL

AREA DE DESCARGA / DUMPING AREA
 ENTRE 50 DME DEL VOR/DME/GDL Y LONVA
 ENTRE VOR/DME/GDL Y VOR/DME/ZIH
 ENTRE 20 Y 100 DME DEL VOR/DME/GDL

TRABAJOS DE DESYERBE
 (EVENTUALES) EN FRANJAS DE
 SEGURIDAD DEL AREA DE
 MOVIMIENTO

EVENTUAL TRIMMING WORKS IN
 SAFETY STRIPS OF THE MOVEMENT
 AREA

PRECAUCION: CRUCE DE AVES POR
 LAS TRAYECTORIAS DE LAS PISTAS

CAUTION: FLOCKS EVENTUALLY
 CROSSING RUNWAY TRACKS