

RWY CHARACTERISTICS				
RWY	DIRECCION / DIRECTION	THR	RESISTENCIA / STRENGTH	TIPO / TYPE
05	047.47°	19°50'27.50" N 101°02'19.02" W	59/F/A/W/T	ASFALTO / ASPHALT
23	227.47°	19°51'31.64" N 101°00'43.53" W		

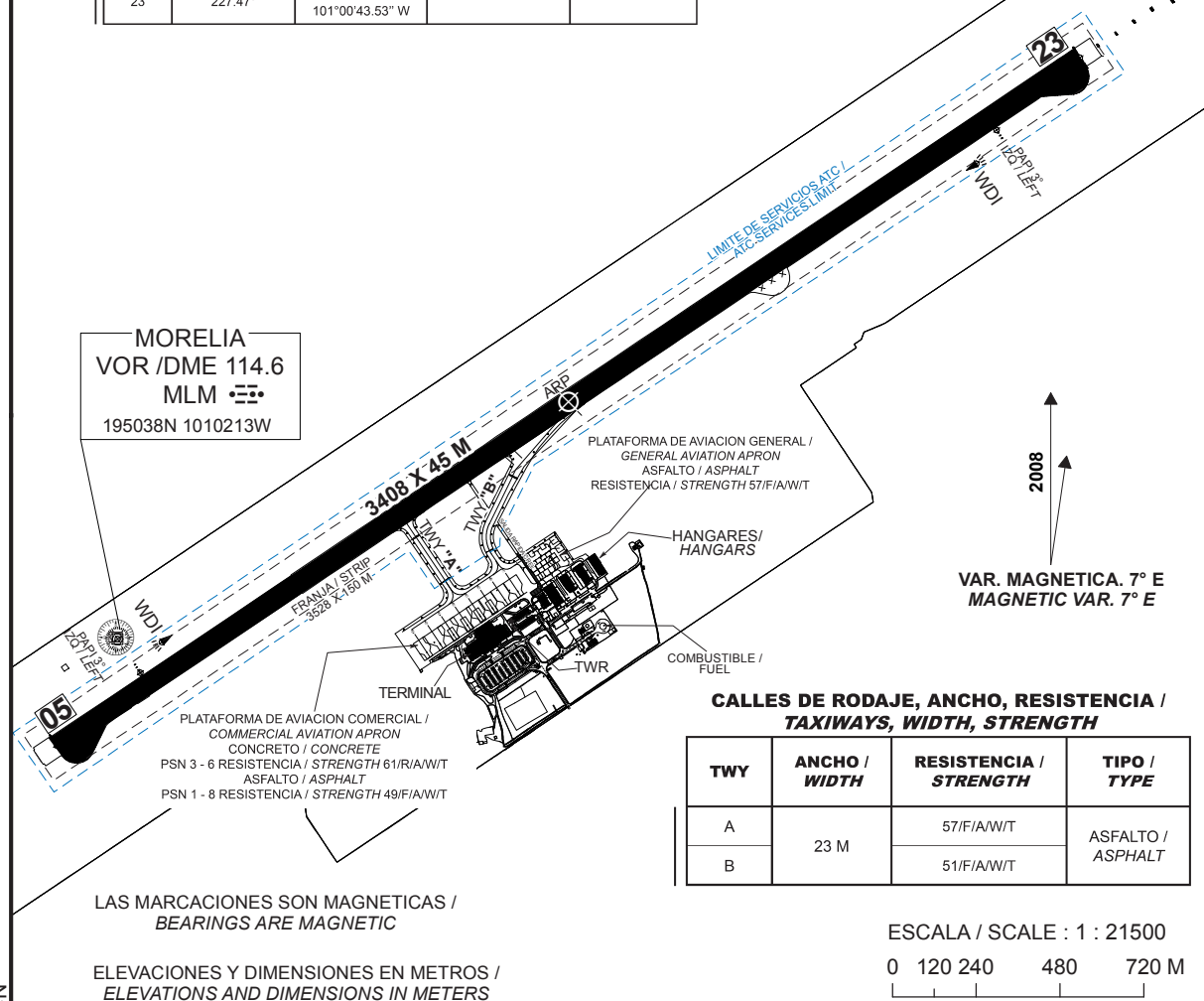

The diagram illustrates a runway layout with the following components:

- Runway 05:** Located at the top of the diagram, oriented horizontally. It features a centerline, edge lines, and various markings including a "50" at the left end.
- Runway 23:** Located at the bottom of the diagram, oriented horizontally. It features a centerline, edge lines, and various markings including a "23" at the right end.
- Taxiway A:** Located in the middle of the diagram, oriented vertically. It connects Runway 05 and Runway 23.
- Taxiway B:** Located on the right side of the diagram, oriented diagonally. It connects Runway 05 and Runway 23.

The diagram includes various markings and dimensions, such as "50" and "23" at the ends of the runways, and "TAXIWAY A" and "TAXIWAY B" labels for the taxiways.

MINIMOS METEOROLOGICOS / METEOROLOGICAL MINIMUMS
TECHO EN FT Y VISIBILIDAD EN SM / CEILING IN FT AND VISIBILITY IN SM

EQUIPO / AIRCRAFT	DESPEGUE / TAKE OFF		ALTERNO MINIMOS / ALTERNATE MINIMUMS
	DIA Y NOCHE / DAY AND NIGHT		
	RWY 05	RWY 23	
1 Y 2 MOTORES / 1 AND 2 ENGINES	500 - 1 (1600 M)	1000 – 1 (1600 M)	2000 – 3 (4800 M)
3 O MAS MOTORES / 3 OR MORE ENGINES	500 - 1/2 (800 M)		

NOTAS / REMARKS:

AERONAVES AL ENTRAR Y SALIR DE PLATAFORMA COMERCIAL DEBEN USAR **POTENCIA MÍNIMA** CUANDO REALICEN **GIRO DE 180°** PARA **EVITAR DAÑOS** MATERIALES AL EDIFICIO

AERONAVES CON PESO DE **10 000 KG O MAYOR** EFECTUAR **VIRAJES DE 180°** ÚNICAMENTE EN GOTA DE **RWY 05/23**

AERONAVES EN POSICIONES **2-6** USAR **REMOLQUE** AL SALIR DE **PLATAFORMA AVIACIÓN COMERCIAL**

TRABAJOS DE DESYERBE (**EVENTUALES**) EN FRANJAS DE SEGURIDAD DEL AREA DE MOVIMIENTO

PRECAUCION: CRUCE DE AVES POR LAS TRAYECTORIAS DE LAS PISTAS

WHEN ENTERING OR LEAVING THE COMMERCIAL APRON, **AIRCRAFT** SHALL USE **MINIMUM POWER** WHEN THEY CARRY OUT A **180° TURN**, SO AS **TO AVOID MATERIAL DAMAGES** TO THE BUILDING

AIRCRAFT WEIGHING **10000 KG OR MORE** SHALL CARRY OUT **180° TURNS** ONLY ON TEARDROP OF **RWY 05/23**

AIRCRAFT AT POSITIONS **2-6** SHALL BE **TOWED** WHEN LEAVING THE **COMMERCIAL AVIATION APRON**

EVENTUAL WEEDING AT SAFETY STRIPS OF THE MOVEMENT AREA

CAUTION: FLUCK OF BIRDS CROSSING THE RUNWAYS TRACKS