

PLANO DE ESTACIONAMIENTO Y ATRAQUE DE AERONAVES /
AIRCRAFT PARKING/DOCKING CHART

ELEV AD 1520.5 M

TWR 118.3
APP 121.1
FPQ 122.30

OAXACA
AEROPUERTO INTL /
INTL AIRPORT

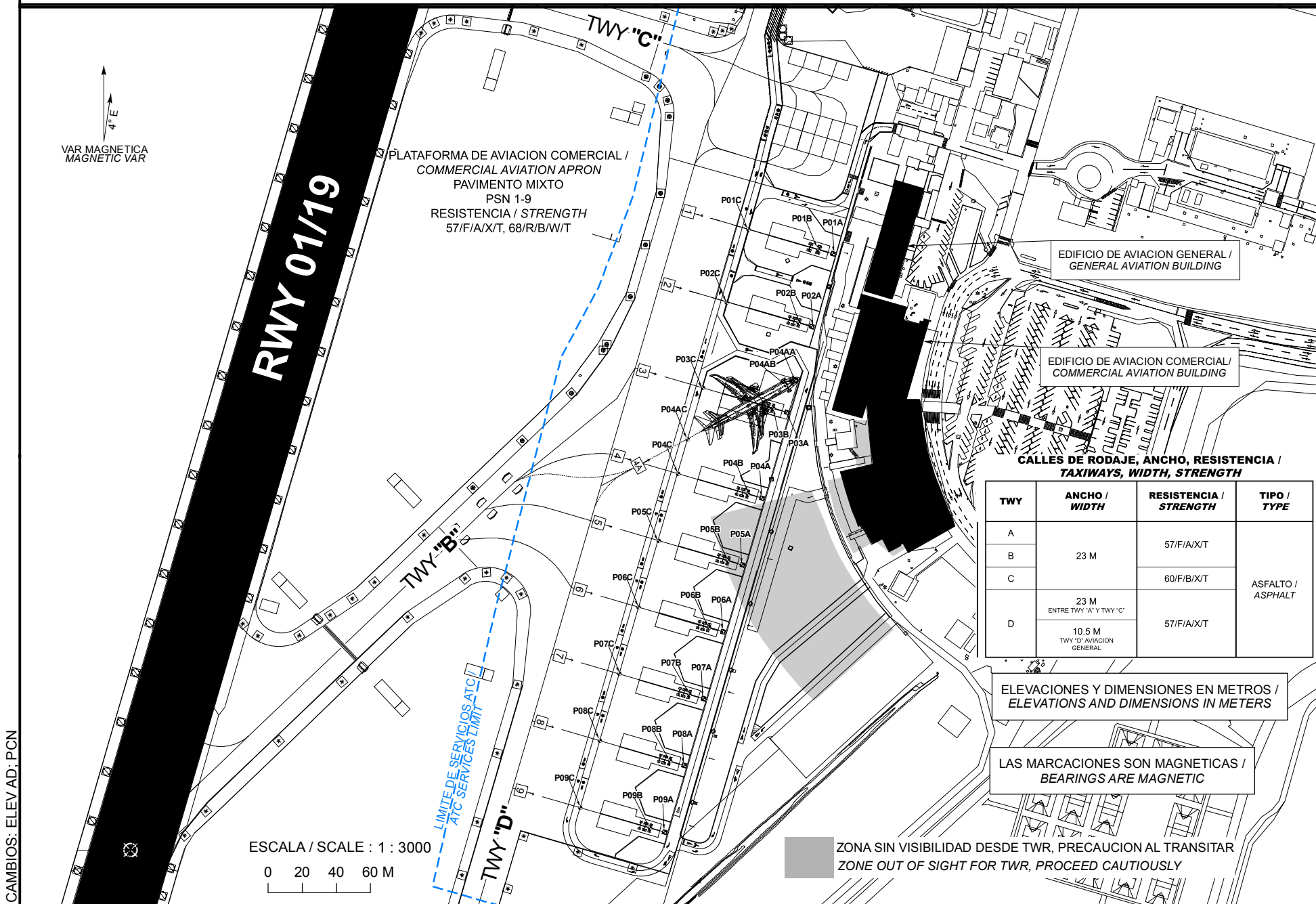

CAMBIOS: ELEV AD: PCN

**COORDENADAS INS DE PUESTOS DE ESTACIONAMIENTO DE AERONAVES AVIACION COMERCIAL /
COORDINATES INS, FOR AIRCRAFT STANDS, COMMERCIAL AVIATION**

POSICION/ POSITION		LAT (N)	LONG (W)
1	P01A	17° 00' 06.31"	096° 43' 20.00"
	P01B	17° 00' 06.40"	096° 43' 20.33"
	P01C	17° 00' 06.77"	096° 43' 21.70"
2	P02A	17° 00' 04.93"	096° 43' 20.41"
	P02B	17° 00' 05.02"	096° 43' 20.75"
	P02C	17° 00' 05.39"	096° 43' 22.11"
3	P03A	17° 00' 03.31"	096° 43' 20.89"
	P03B	17° 00' 03.39"	096° 43' 21.21"
	P03C	17° 00' 03.76"	096° 43' 22.59"
4	P04A	17° 00' 01.67"	096° 43' 21.36"
	P04B	17° 00' 01.76"	096° 43' 21.69"
	P04C	17° 00' 02.14"	096° 43' 23.07"
4A	P04AA	17° 00' 03.93"	096° 43' 20.77"
	P04AB	17° 00' 03.83"	096° 43' 20.94"
	P04AC	17° 00' 02.80"	096° 43' 22.87"
5	P05A	17° 00' 00.41"	096° 43' 21.73"
	P05B	17° 00' 00.49"	096° 43' 22.06"
	P05C	17° 00' 00.87"	096° 43' 23.44"
6	P06A	16° 59' 59.14"	096° 43' 22.10"
	P06B	16° 59' 59.23"	096° 43' 22.43"
	P06C	16° 59' 59.60"	096° 43' 23.81"
7	P07A	16° 59' 57.87"	096° 43' 22.47"
	P07B	16° 59' 57.96"	096° 43' 22.80"
	P07C	16° 59' 58.33"	096° 43' 24.18"
8	P08A	16° 59' 56.61"	096° 43' 22.84"
	P08B	16° 59' 56.69"	096° 43' 23.17"
	P08C	16° 59' 57.07"	096° 43' 24.55"
9	P09A	16° 59' 55.34"	096° 43' 23.21"
	P09B	16° 59' 55.42"	096° 43' 23.54"
	P09C	16° 59' 55.80"	096° 43' 24.92"