

PLANO DE ESTACIONAMIENTO Y ATRAQUE DE AERONAVES/
AIRCRAFT PARKING/DOCKING CHART

ELEV AD 7 M

TWR
APP
RAMPA

118.5
119.0 / 121.3
134.1

PUERTO VALLARTA

AEROPUERTO INTL /
INTL AIRPORT

LIC GUSTAVO DIAZ ORDAZ

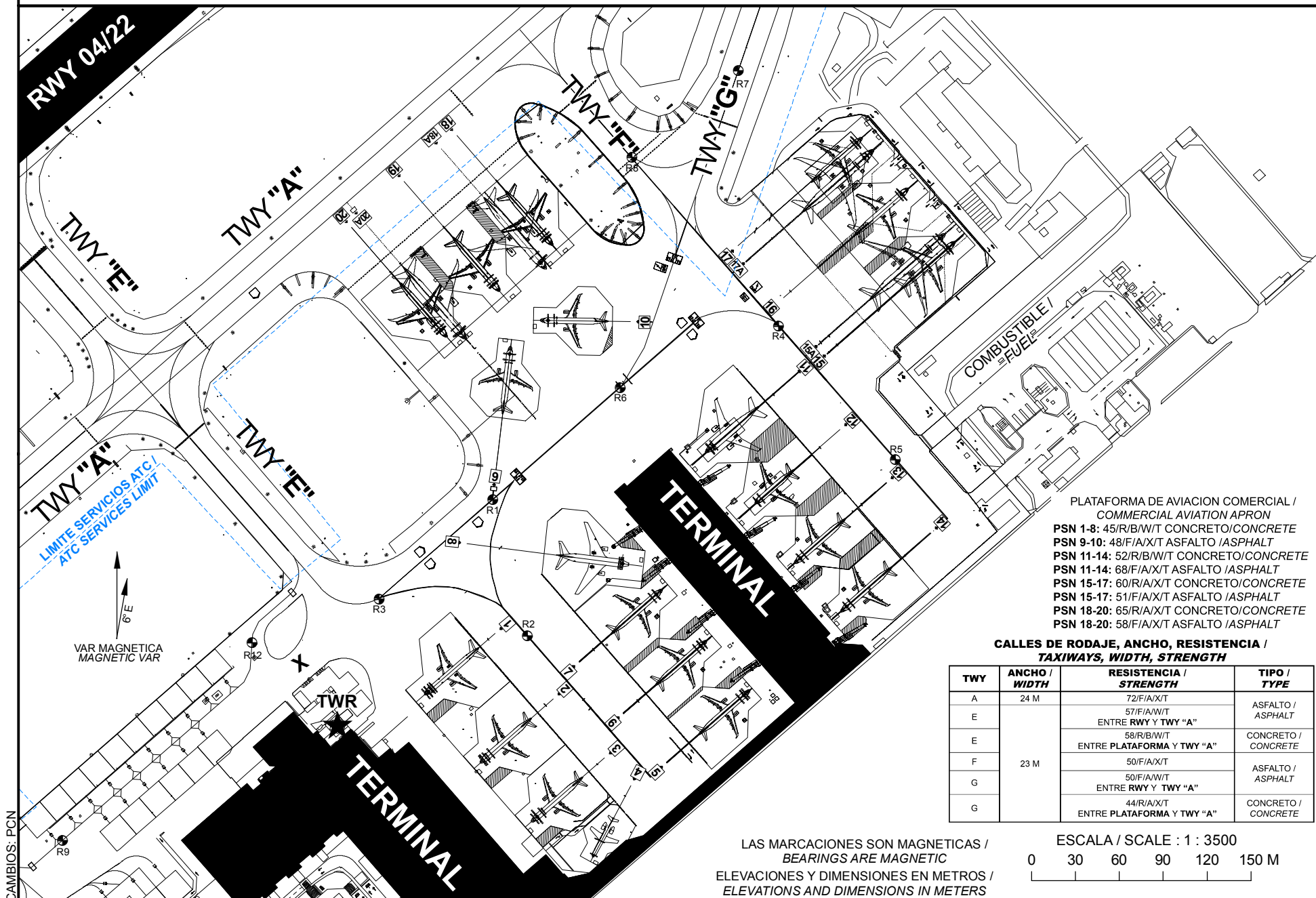

PLATAFORMA DE AVIACION COMERCIAL /
COMMERCIAL AVIATION APRON
PSN 1-8: 45/R/B/W/T CONCRETO/CONCRETE
PSN 9-10: 48/F/A/X/T ASFALTO /ASPHALT
PSN 11-14: 52/R/B/W/T CONCRETO/CONCRETE
PSN 11-14: 68/F/A/X/T ASFALTO /ASPHALT
PSN 15-17: 60/R/A/X/T CONCRETO/CONCRETE
PSN 15-17: 51/F/A/X/T ASFALTO /ASPHALT
PSN 18-20: 65/R/A/X/T CONCRETO/CONCRETE
PSN 18-20: 58/F/A/X/T ASFALTO /ASPHALT

**CALLES DE RODAJE, ANCHO, RESISTENCIA /
TAXIWAYS, WIDTH, STRENGTH**

TWY	ANCHO / WIDTH	RESISTENCIA / STRENGTH	TIPO / TYPE
A	24 M	72/F/A/X/T	ASFALTO / ASPHALT
E	23 M	57/F/A/W/T ENTRE RWY Y TWY "A"	ASFALTO / ASPHALT
E		58/R/B/W/T ENTRE PLATAFORMA Y TWY "A"	CONCRETO / CONCRETE
F		50/F/A/X/T	ASFALTO / ASPHALT
G		50/F/A/W/T ENTRE RWY Y TWY "A"	
G		44/R/A/X/T ENTRE PLATAFORMA Y TWY "A"	CONCRETO / CONCRETE

LAS MARCACIONES SON MAGNETICAS /
BEARINGS ARE MAGNETIC
ELEVACIONES Y DIMENSIONES EN METROS /
ELEVATIONS AND DIMENSIONS IN METERS

ESCALA / SCALE : 1 : 3500

0 30 60 90 120 150 M

**COORDENADAS INS DE PUESTOS DE ESTACIONAMIENTO DE AERONAVES AVIACION COMERCIAL /
COORDINATES INS, FOR AIRCRAFT STANDS, COMMERCIAL AVIATION**

POSICION/ POSITION	LAT (N)	LONG (W)	AERONAVE/ AIRCRAFT	RESISTENCIA/ STENGTH	TIPO/ TYPE
1	20° 40' 45.32"	105° 14' 55.05"	A-321-200	45/R/B/W/T	CONCRETO/ CONCRETE
2	20° 40' 43.94"	105° 14' 53.69"			
3	20° 40' 42.71"	105° 14' 52.49"			
4	20° 40' 41.93"	105° 14' 51.17"	EMB-145		
5	20° 40' 45.44"	105° 14' 47.87"	A-321-200		
6	20° 40' 46.47"	105° 14' 48.89"			
7	20° 40' 47.54"	105° 14' 49.93"			
8	20° 40' 48.18"	105° 14' 50.72"	B-787-8		
9	20° 40' 52.59"	105° 14' 53.43"	A-321-200	48/F/A/X/T	ASFALTO/ ASPHALT
10	20° 40' 53.33"	105° 14' 52.58"			
11	20° 40' 50.69"	105° 14' 48.81"	A-310-300	52/R/B/W/T 68/F/A/X/T	CONCRETO/ CONCRETE ASFALTO/ ASPHALT
12	20° 40' 49.58"	105° 14' 47.71"	A-321-200		
13	20° 40' 48.40"	105° 14' 46.69"			
14	20° 40' 47.40"	105° 14' 45.60"			
15	20° 40' 55.14"	105° 14' 43.54"	B-757-200	60/R/A/X/T 51/F/A/X/T	CONCRETO/ CONCRETE ASFALTO/ ASPHALT
15A	20° 40' 55.34"	105° 14' 43.73"	A-350-9		
16	20° 40' 56.25"	105° 14' 44.64"	B-757-200		
17A	20° 40' 57.01"	105° 14' 45.51"	B-787-9		
17	20° 40' 57.33"	105° 14' 45.70"	A-321-200	65/R/A/X/T 58/F/A/X/T	CONCRETO/ CONCRETE ASFALTO/ ASPHALT
18	20° 40' 55.08"	105° 14' 52.67"	B-757-200		
18A	20° 40' 54.55"	105° 14' 52.78"	B-787-9		
19	20° 40' 54.07"	105° 14' 53.84"	B-757-200		
20A	20° 40' 53.01"	105° 14' 54.56"	B-787-9		
20	20° 40' 53.05"	105° 14' 55.01"	B-757-200		

**COORDENADAS PUNTOS DE TRANSFERENCIA /
HAND OFF POINTS COORDINATES**

POSICION/ POSITION	LAT (N)	LONG (W)
R1	20° 40' 49.482443"	105° 14' 53.710938"
R2	20° 40' 46.4609"	105° 14' 52.7881"
R3	20° 40' 47.2717"	105° 14' 56.2951"
R4	20° 40' 53.336778"	105° 14' 47.325124"
R5	20° 40' 50.5924"	105° 14' 44.6018"
R6	20° 40' 51.944045"	105° 14' 50.912623"
R7	20° 40' 59.2363"	105° 14' 48.1995"
R8	20° 40' 56.8653"	105° 14' 50.7878"
R9	20° 40' 41.754131"	105° 15' 03.42663"
R10	20° 40' 40.957999"	105° 15' 02.890195"
R11	20° 40' 39.904517"	105° 15' 04.622559"
R12	20° 40' 46.512322"	105° 14' 59.068845"